

Auger sampler MST / AST / EST 48

For solids

New design!

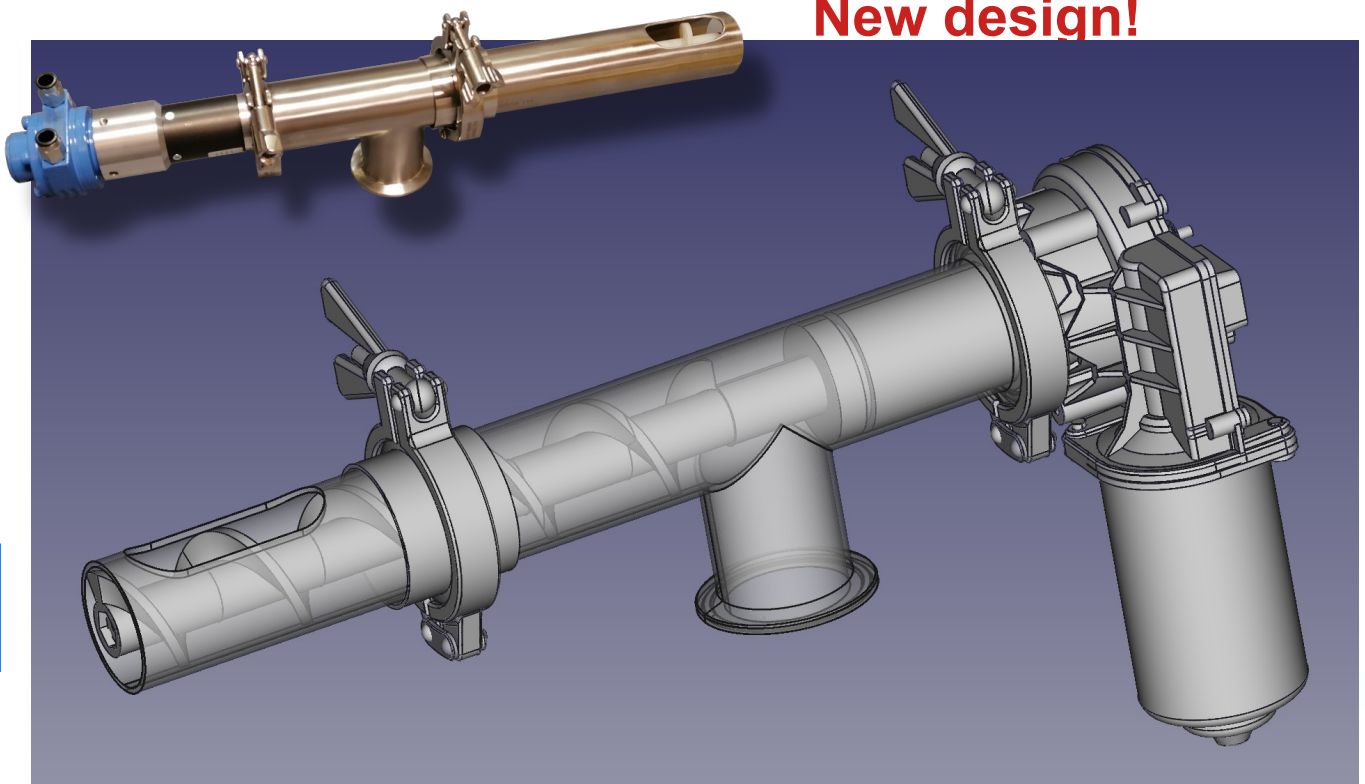

Product information



Application

The sampling systems enable continuous, representative and reproducible sampling of any quantities of accumulating, slipping or free-falling solids with particle sizes <10mm. After sampling, the sample falls into any collection system, which is attached to the ejection nozzle with a 63mm triclamp ferrule.

The device is characterized by its uncomplicated installation and reliable mode of operation. The sample quantity can be freely determined via the actuation time. In the driven version and with appropriate control a sampling proportional to time, volume or event can be realized.

Operation

A screw conveys the product through the extraction tube. The sample falls from the ejection port into a sample container. The screw conveyor is driven manually by a crank (type M), a pneumatic geared motor or a 24V electric motor. Product residues remaining in the housing are removed from the sampling tube by reverse operation so that the sample is always "fresh".

Mounting and installation

For mounting the sampler, the supplied TC flange DN50 is welded into the wall of the pipe or chute. The sampler is attached to it with a triclamp. Optionally, a sample collection system is connected to the ejector. For pressure or vacuum applications, a shut-off device should be installed between the sampler and the collection container.

Slip'n'fix

The penetration length can be adjusted.



Features:

- Suitable for powders and granulates, but also for slurries/pastes
- Easy to install: One flange is sufficient
- Auger material polyamide 6.6 or stainless steel 316L
- Easy to clean
- Any sample container adaptable
- simple manual control or programmable control box available
- Various material and design options

Design variants

Modell	Antrieb	Penetration	Auger type
AST 48-P	Pneumatic 120 U/min ¹	70 - 180mm	Polyamide segmented ³
MST 48-P	manual	70 - 180mm	Polyamide segmented ³
EST 48-P	Electric, 24VDC 85 rpm ²	70 - 180mm	Polyamide segmented ³
AST 48-S	Pneumatic 120 U/min ¹	70 - 180mm	Stainless 316L, segmented ³
MST 48-S	manual	70 - 180mm	Stainless 316L, segmented ³
EST 48-S	Electric, 24VDC 85 rpm ²	70 - 180mm	Stainless 316L, segmented ³

¹ Pneumatic geared motor, stall-proof and reversible, requires 4-6 bar compressed air. Bulk head fitting 8mm

Recommended valve: 3/2 way, mind 400l /min.

with reverse operation: 2 x 3/2 way, mind 400l /min.

² Doga geared DC motor 24 VDC, 3,5A nom./ 30 A max., IP 65

³ Polyamid PA66, for temperatures up to 95°C

⁴ machined from solid bar and polished to Ra=0,8µm , no welds!

Options

- Collection systems
- Control boxes, programable
- Shut-off valve for pressure or vacuum applications
- Upgrade for use in ATEX areas



QAQC LAB

www.qclabequipment.com